



Brazeau County

7401 – Twp Rd 494, P.O. Box 77, Drayton Valley, Alberta T7A-1R1
PHONE: (780) 542-7777 - FAX: (780) 542-7770
www.brazeau.ab.ca

NOTICE OF CONSTRUCTION

HAMLET OF CYNTHIA INFRASTRUCTURE REHABILITATION – PHASE-2 (AREAS 1&2)
PROJECT NO.: WAT- 0001 & WSWT- 0002

Why am I receiving this notice?

Brazeau County (the County) would like to inform you that the County will be undertaking construction of the Hamlet of Cynthia Infrastructure Rehabilitation Phase-2 (refer to facility map enclosed) during summer and fall of 2017.

Why this construction is needed?

This construction is needed because existing infrastructure has passed its design and economic life particularly, the sanitary sewer is at least 50 years old. Rehabilitation of underground services will enhance and support future development and satisfy current environmental standards.

What will this project consist of?

This project will consist of rehabilitation of existing sanitary sewer, watermains, drainage (culverts and ditches) and roads infrastructure.

Who will maintain the utilities and access to residents throughout the construction period?

The successful bidder/contractor will maintain all the utilities and access to all residents throughout the construction period.

When will construction occur and how long will it last?

Construction is expected to begin middle of August, 2017 and is expected to reach completion in the last week of November 2017.

What will be the impact?

As with any construction, it is expected that local traffic and access ways may be impacted.

Thank you for your patience!

The County recognizes that the construction will be an inconvenience to certain residents of the Hamlet of Cynthia. We appreciate your understanding during the construction period of 2017.

Who can I speak to if I have a question?

Please feel free to contact: Mr. Bhupesh Sakalley with PWI at BSakalley@brazeau.ab.ca @ telephone # 780-542-7777 or Ms. Jenna Durkee with PWI at JDurkee@brazeau.ab.ca or telephone # 780-542-7777.

Winston Rossouw
Director, Public Works & Infrastructure

Produced by
Bureau County
February 11, 2008



Cynthia
E1/2 S-50-10-W5M
1 3200
5002 S1 St - Rural Address
1989S:17-D - Plan, Block, Lot

1988 8 Incht Cement
Year Installed: Pipe Size:
Water
Sewer

Cynthia Water Station
Cynthia Solar Aquatics

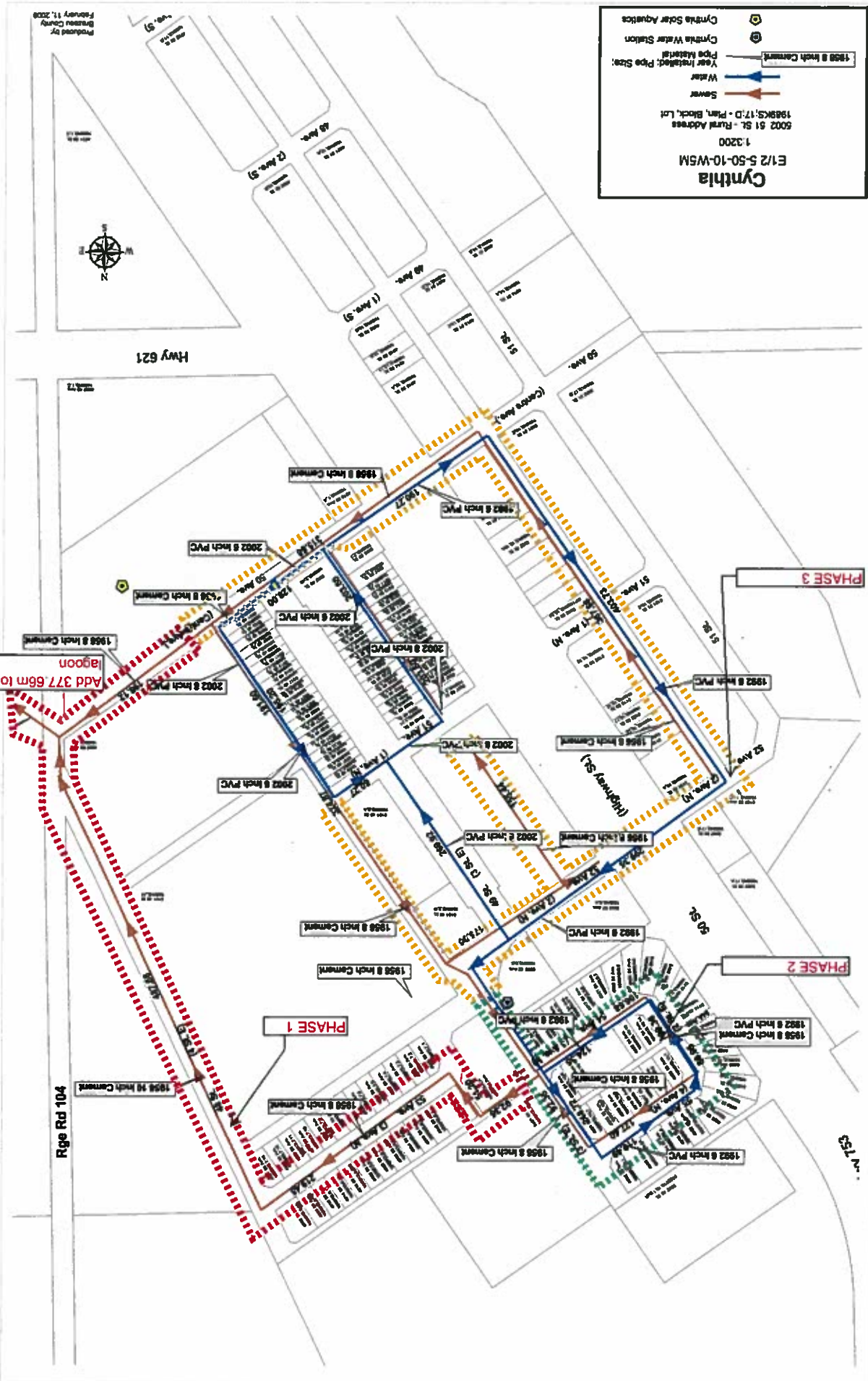

Add 377.66m to
lagoon

PHASE 3

PHASE 2

PHASE 1

Rge Rd 104

W 753

Hwy 621

50 Ave.

51 Ave.

52 Ave.

53 Ave.

54 Ave.

55 Ave.

56 Ave.

57 Ave.

58 Ave.

59 Ave.

60 Ave.

61 Ave.

62 Ave.

63 Ave.

64 Ave.

65 Ave.

66 Ave.

67 Ave.

68 Ave.

69 Ave.

70 Ave.

71 Ave.

72 Ave.

73 Ave.

74 Ave.

75 Ave.

76 Ave.

77 Ave.

78 Ave.

79 Ave.

80 Ave.

81 Ave.

82 Ave.

83 Ave.

84 Ave.

85 Ave.

86 Ave.

87 Ave.

88 Ave.

89 Ave.

90 Ave.

91 Ave.

92 Ave.

93 Ave.

94 Ave.

95 Ave.

96 Ave.

97 Ave.

98 Ave.

99 Ave.

100 Ave.